

Field Instructions RAPID EXTRACTION METHOD

- Check Expiry Date
 - Check Desiccant Pouch:
Blue = OK
Pink = Do not use test

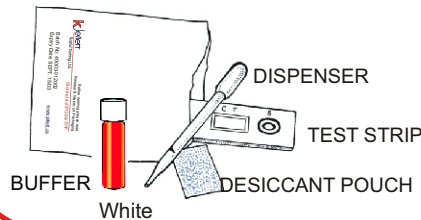

- Before using, hold buffer vial as shown, 1 inch above table.

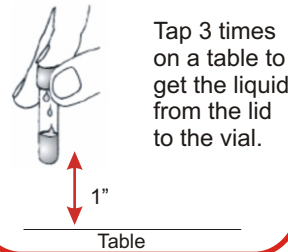

- Add 100 µL of shellfish extract (to black line of dispenser) to the vial in step 2.

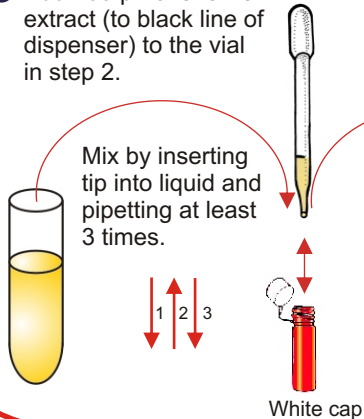

- Place 100 µL of the mixture into sample well "S".

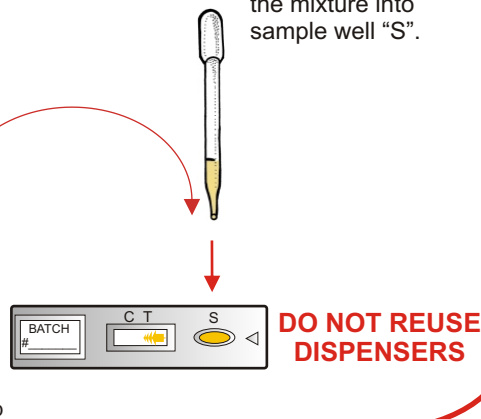

- Read your results between 35 minutes and one hour. Turn this page for C & T Line Interpretation.

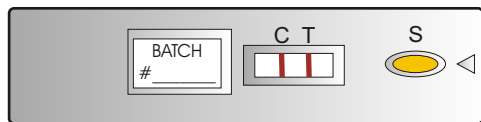

JELLETT RAPID TESTING LTD.

4654 Route #3, Chester Basin, Nova Scotia, Canada B0J 1K0
www.jellett.ca • Tel: (902) 275-5104 • Fax: (902) 275-2242

Line Interpretation

T-line

As the toxin level increases the T-line becomes fainter. If your T-line is darker than the Positive T-line below, the test is **Negative**. If your T-line is equal to or fainter than the Positive T-line below, the test is **Positive**. When in doubt, consider the test **Positive**.

A **Negative** T-line

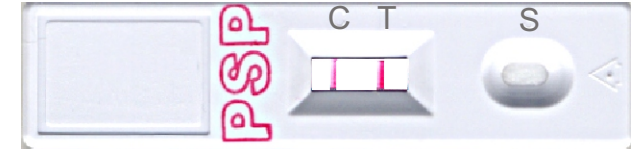

A **Positive** T-line

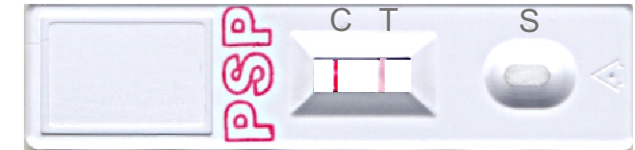

Be Safe!

We Recommend Placing Your Cassette Here for Comparison Purposes

Example of an Invalid Test

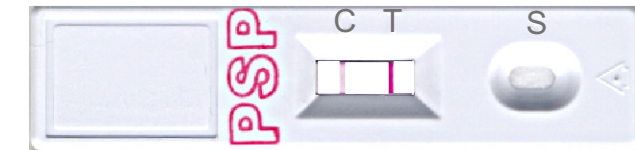

C-line

If your C line is equal to or fainter than the invalid test above, your test is invalid. Repeat the assay with a new test. If the same result occurs, your sample contains an unknown agent that inhibits the antibody/antigen reaction; an alternative testing method should be used.

If you need assistance, if invalids persist or if you have any other problems, contact us at techsupp@jellett.ca
Technical Assistance:

- 1) Scan or photograph your problem cassettes before they completely dry.
- 2) Save and refrigerate your extract.
- 3) Call for shipping instructions before sending us extracts or tissue.